

PROPOSED PLAN

E.S.H EDGE
P.S.H EDGE
MEDIAN EDGE
CENTER LINE
HOR. TANGENT POINT
VIADUCT
BOX CULVERT

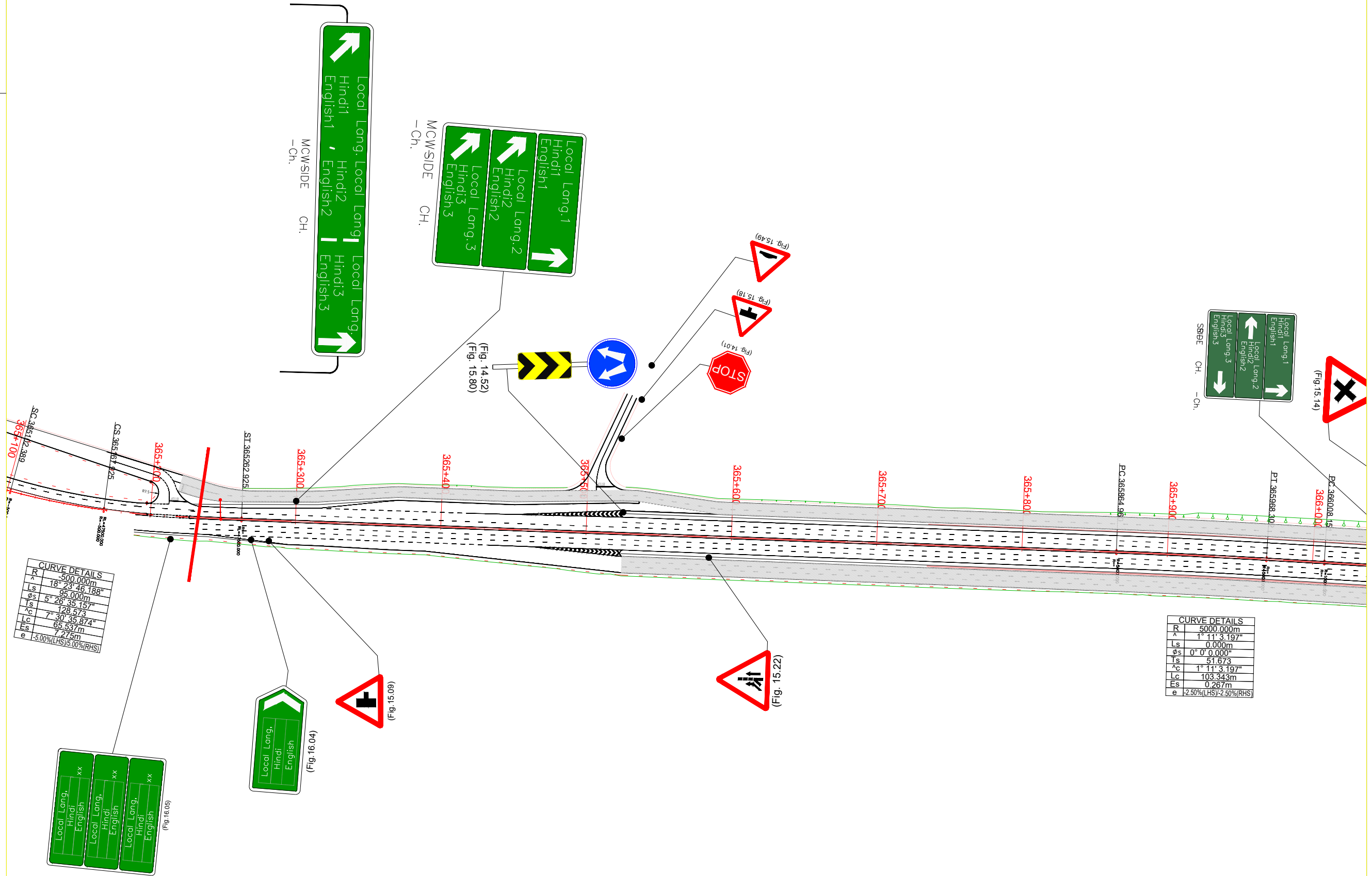

REV.	DATE	DESCRIPTION

AUTHORITY:

NATIONAL HIGHWAYS
AUTHORITY OF INDIA
(Ministry of Shipping, Road Transport and Highways)



DPR CONSULTANT

M/S CHAITANYA PROJECTS
CONSULTANCY PVT. LTD.



IN ASSOCIATION WITH

MSPARK FUTURISTICS &
ASSOCIATES



NAME OF PROJECT

CONSULTANCY SERVICES FOR PREPARATION OF
DETAILED PROJECT REPORT (DPR) FOR
DEVELOPMENT OF VARIOUS PORT CONNECTIVITY
STRETCHES UNDER PORT CONNECTIVITY MASTER
PLAN OF KIOCL FLYOVER IN THE STATE OF
KARNATAKA.

DRAWN	S.S.
DESIGNED	A.S.
PROOF CHECKED	
APPROVED	

TITLE: ROAD FURNITURE PLAN AT (CH: 365+200 TO CH: 366+000)	
SCALE: HOR - (1:2000) VER - (1:200)	DRG. NO: CP/MSPARK/KIOCL-01

DATE: "FEB., 2026"
SHEET 01 OF 04
REV: R0

PROPOSED PLAN

E.S.H EDGE
P.S.H EDGE
MEDIAN LINE
CENTER LINE
HOR. TANGENT POINT
VIADUCT
BOX CULVERT

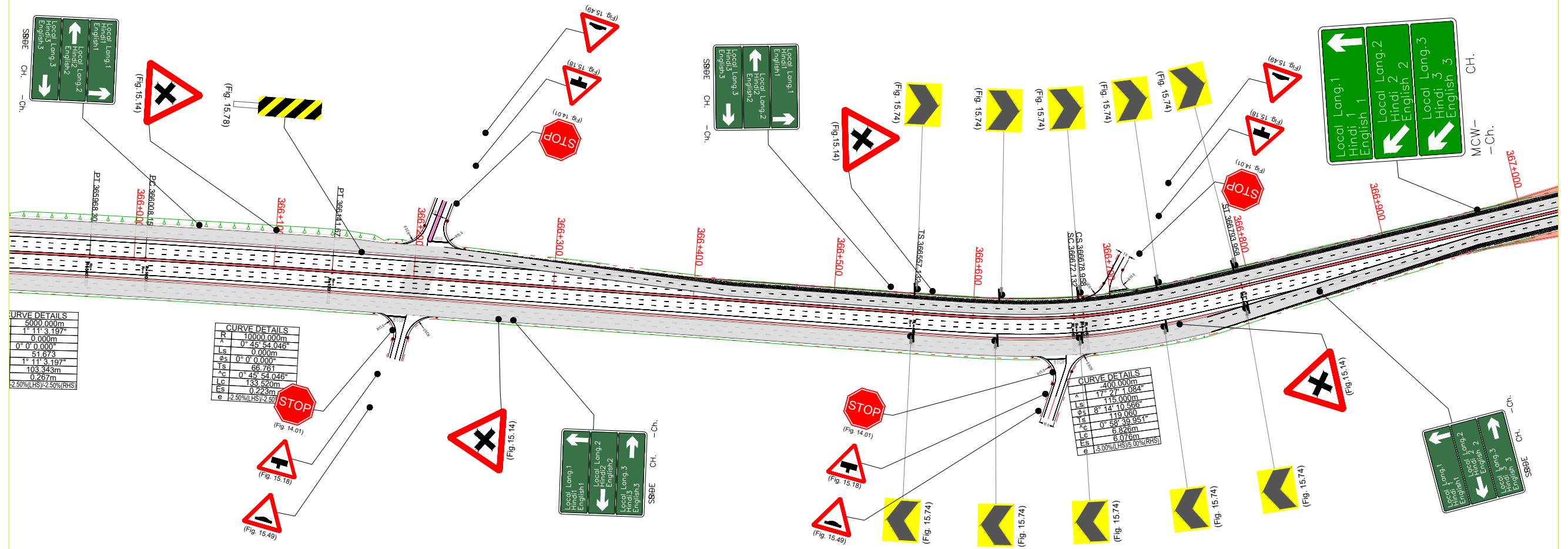

REV.	DATE	DESCRIPTION

AUTHORITY:

NATIONAL HIGHWAYS
AUTHORITY OF INDIA
(Ministry of Shipping, Road Transport and Highways)

DPR CONSULTANT

M/S CHAITANYA PROJECTS
CONSULTANCY PVT. LTD.

IN ASSOCIATION WITH

MSPARK FUTURISTICS &
ASSOCIATES

NAME OF PROJECT

CONSULTANCY SERVICES FOR PREPARATION OF
DETAILED PROJECT REPORT (DPR) FOR
DEVELOPMENT OF VARIOUS PORT CONNECTIVITY
STRETCHES UNDER PORT CONNECTIVITY MASTER
PLAN OF KIOCL FLYOVER IN THE STATE OF
KARNATAKA.

DRAWN	S.S.
DESIGNED	A.S.
PROOF CHECKED	
APPROVED	

TITLE:

ROAD FURNITURE PLAN
AT (CH: 366+000 TO CH: 367+000)

SCALE:

HOR - (1:2000)
VER - (1:200)

DRG. NO:

CP/MSPARK/KIOCL-02

DATE:

"FEB., 2026"

SHEET

02 OF 04

REV:

R0

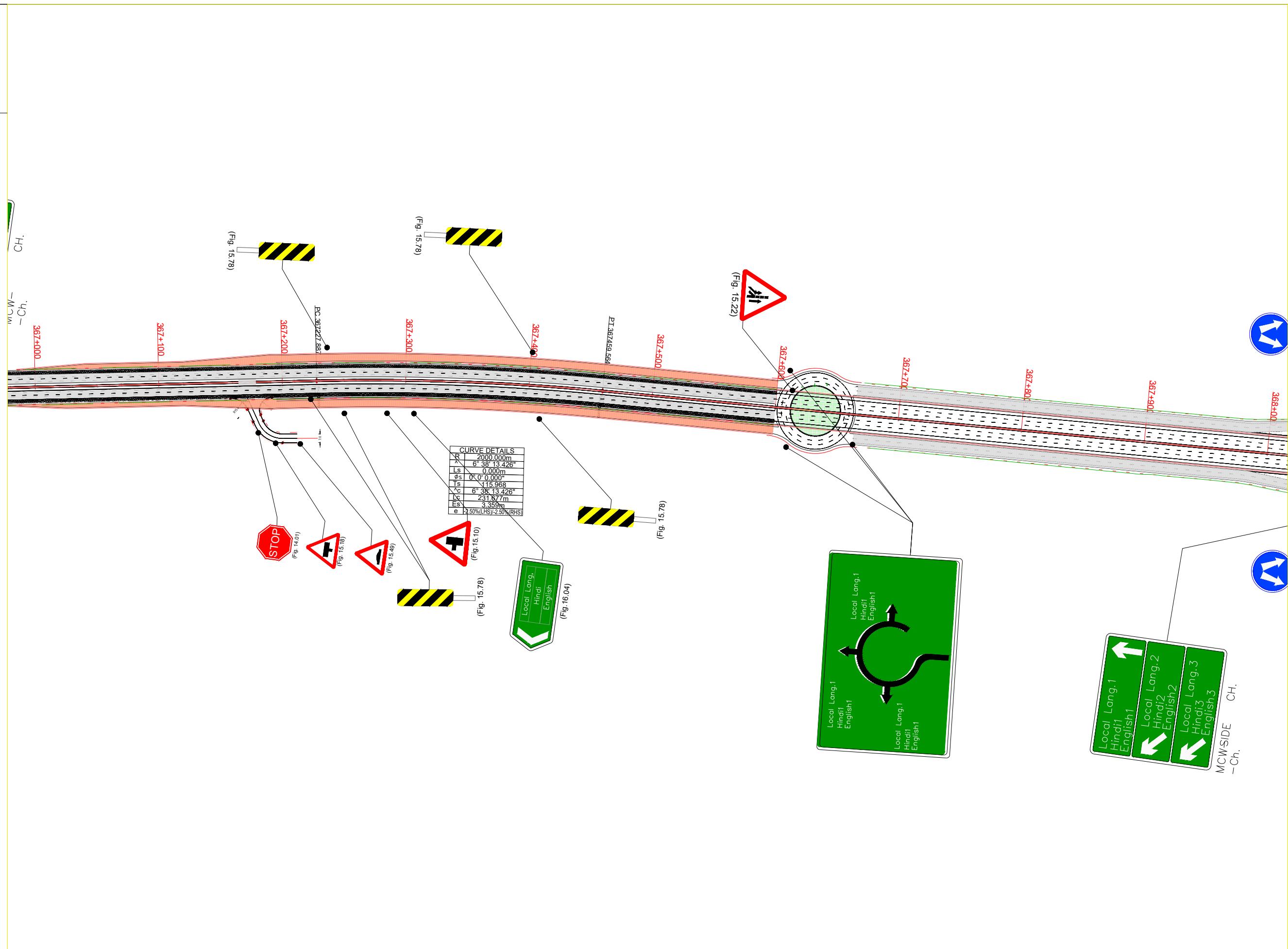

DATE:
"FEB., 2026"

SHEET
03 OF 04

REV:
R0

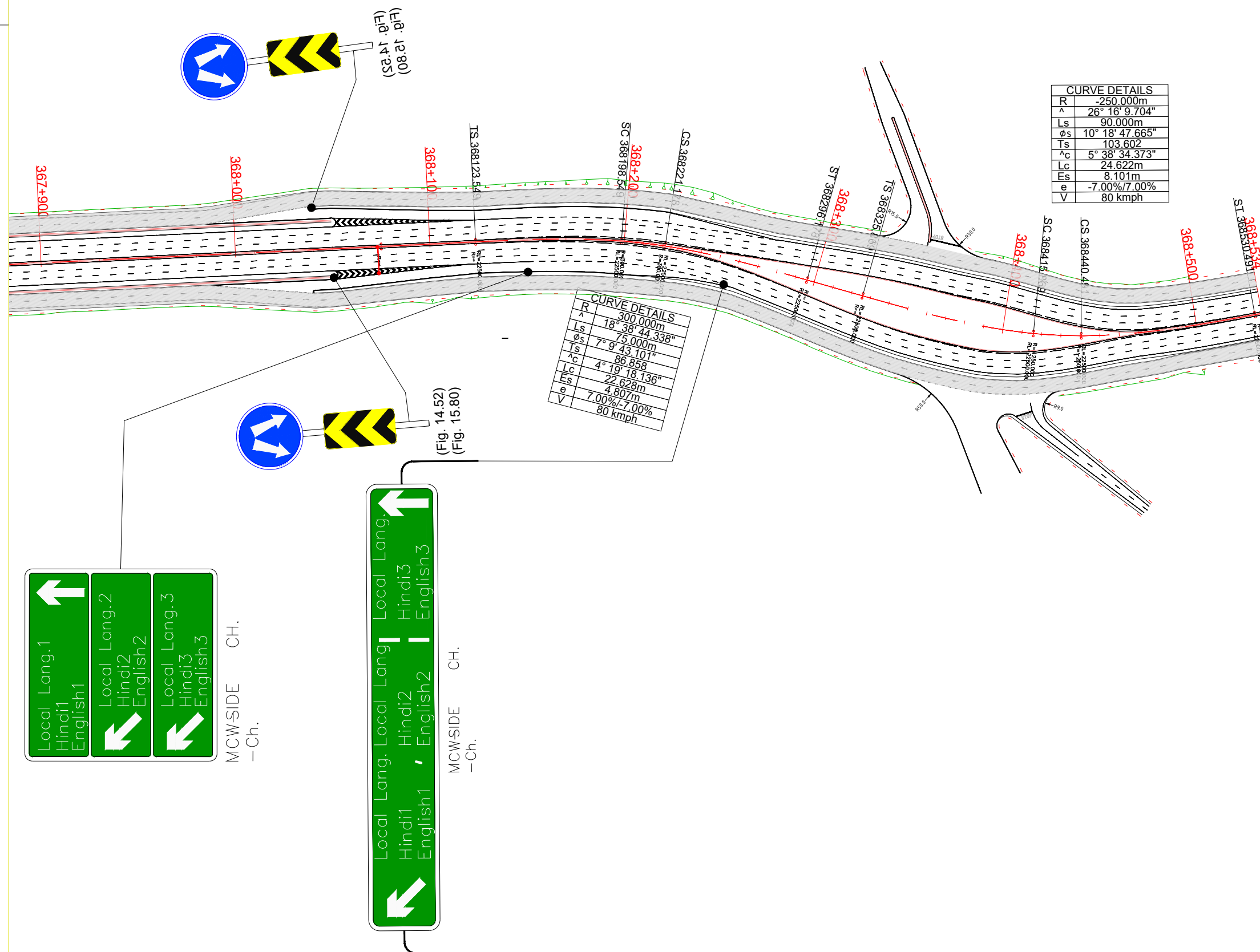

CURVE DETAILS	
R	-250.000m
Δ	26° 16' 9.704"
Ls	90.000m
ϕ_s	10° 18' 47.665"
Ts	103.602
Δ_c	5° 38' 34.373"
Lc	24.622m
Es	8.101m
e	-7.00%(7.00%)
V	80 kmph

CURVE DETAILS	
R	300.000m
Δ	$18^{\circ} 38' 44.338''$
Ls	75.000m
ϕ_s	$7^{\circ} 9' 43.101''$
Ts	86.858
α_c	$4^{\circ} 19' 18.136''$
Lc	22.628m
Es	4.807m
e	7.00%-7.00%
V	80 kmph

[illegible]

AUTHORITY:

**NATIONAL HIGHWAYS
AUTHORITY OF INDIA**
(Ministry of Shipping, Road Transport and Highways)



OPR CONSULTANT
M/S CHAITANYA PROJECTS
CONSULTANCY PVT. LTD.
IN ASSOCIATION WITH
MSPARK FUTURISTICS &
ASSOCIATES

NAME OF PROJECT
CONSULTANCY SERVICES FOR PREPARATION OF DETAILED PROJECT REPORT (DPR) FOR DEVELOPMENT OF VARIOUS PORT CONNECTIVITY STRETCHES UNDER PORT CONNECTIVITY MASTER PLAN OF KIOCL FLYOVER IN THE STATE OF KARNATAKA.

DRAWN	S.S.
DESIGNED	A.S.
PROOF CHECKED	
APPROVED	

TITLE: ROAD FURNITURE PLAN AT (CH: 368+000 TO CH: 368+534)		DATE: "FEB., 2026"
SCALE: HOR - (1:2000) VER - (1:200)	DRG. NO: CP/MSPARK/KIOCL-04	SHEET 04 OF 04 REV: R0